

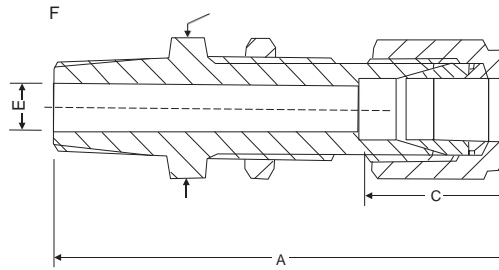

Dimensional Details :



Notes : Drawings are not to scale

Dimensional Details

Dimension, in.

| Tube OD | NPT Male Thread Size | Part Number | A | C | E | F | Panel Hole Size | Max Panel Thickness |
|-----------------------|----------------------|-------------------|------|------|------|-------|-----------------|---------------------|
| 1/8 | 1/8 | S2CMBH2N | 1.83 | 0.50 | 0.09 | 1/2 | 21/64 | 0.50 |
| 1/4 | 1/8 | S4CMBH2N | 1.95 | 0.60 | 0.19 | 5/8 | 29/64 | 0.40 |
| 1/4 | 1/4 | S4CMBH4N | 2.13 | 0.60 | 0.19 | 5/8 | 29/64 | 0.40 |
| 3/8 | 1/4 | S6CMBH4N | 2.26 | 0.66 | 0.28 | 3/4 | 37/64 | 0.44 |
| 3/8 | 3/8 | S6CMBH6N | 2.26 | 0.66 | 0.28 | 3/4 | 37/64 | 0.44 |
| 3/8 | 1/2 | S6CMBH8N | 2.51 | 0.66 | 0.28 | 7/8 | 37/64 | 0.44 |
| 1/2 | 3/8 | S8CMBH6N | 2.49 | 0.90 | 0.38 | 15/16 | 49/64 | 0.50 |
| 1/2 | 1/2 | S8CMBH8N | 2.71 | 0.90 | 0.41 | 15/16 | 49/64 | 0.50 |
| 3/4 | 3/4 | S12CMBH12N | 3.00 | 0.96 | 0.62 | 1 3/1 | 11/64 | 0.66 |
| Dimersion, mm. | 1 | S16CMBH16N | 3.67 | 1.23 | 0.88 | 1 5/8 | 1 21/64 | 0.75 |

| Tube OD | NPT Male Thread Size | Part Number | A | C | E | F | Panel Hole Size | Max Panel Thickness |
|---------|----------------------|-------------------|------|------|-----|----|-----------------|---------------------|
| 6 | 1/4 | SM6CMBH4N | 53.6 | 15.3 | 4.8 | 16 | 11.5 | 10.2 |
| 12 | 1/2 | SM12CMBH8N | 68.8 | 22.8 | 9.5 | 24 | 19.5 | 12.7 |

Dimensions and specifications shown are approximate, may vary from time to time.

- Note :**
1. A and C dimensions are typical finger-tight
 2. Other Threading available on request